

Like

Tweet

+1

**RU**  
RESIDENCY UNLIMITED

**JUNE 2014  
NEWSLETTER**

**TONIGHT, we hope to see you** at the opening of the exhibition "[Maria Laet & Aung Myat Htay: Encounters / Jaro 3](#)" at Rooster gallery (LES).

**SAVE THE DATE of Sunday July 20th (5-8pm)** for RU's annual fundraiser benefit! At this occasion, RU will renew its Raffle Ticket opportunity that was launched last year. The winning artist will be invited to spend 5 weeks in residency at SASA Art Projects in Phnom Penh (Cambodia) with all expenses covered. Tickets will be available starting the first week in July for purchase online.

This month we are pleased to report exciting updates about 2013 RU Alumni. [Rodrigo Braga](#) received the prestigious [2015 SAM Art Projects](#). [Jakub Szczesny](#) is entering the MOMA collection as part of a [new exhibition](#) opening on July 2.

Residency programs are defined by the residents who come and go. In June we welcome the Polish curator [Anna Smolak](#), Taiwanese artist [Ta-Wei Huang](#), and New York based artist [Daniel Horowitz](#) who will be occupying a studio graciously provided by our [partner Pioneer Works](#).

This month, mark your calendars for the following RU public programs :  
-June 5th, join us at the exhibition "[Maria Laet & Aung Myat Htay: Encounters/Jaro 3](#)" at Rooster gallery; June 11th, [Mikkel Carl and Pedro Wirz](#) will create a site sensitive show. Site specific concerns continue with a public walk orchestrated by [Anna Smolak](#) on June 23 that responds to RU's architecture and to her interactions with RU residents. On June 24, [Regine Basha and Cadu](#) review together the artist's work since a decade, followed on June 26th by a [screening of Special Features](#), a film program conceived by RU that commissions 4 local artists to produce a film that takes the RU space into consideration.

Each month we conclude this newsletter with an inquiry about the [Lanchonete Project in Sao Paolo](#), one of the most innovative residency initiatives we know of. Founding Director Todd Lester examines the notion of Power in relation to

Lanchonete. [Click here to find out what is going on.](#)

# RU PUBLIC PROGRAMS

---

## RU Exhibition: Maria Laet & Aung Myat Htay: Encounters / Jaro 3

An exhibition proposal curated by Caroline Taylor at Rooster Gallery

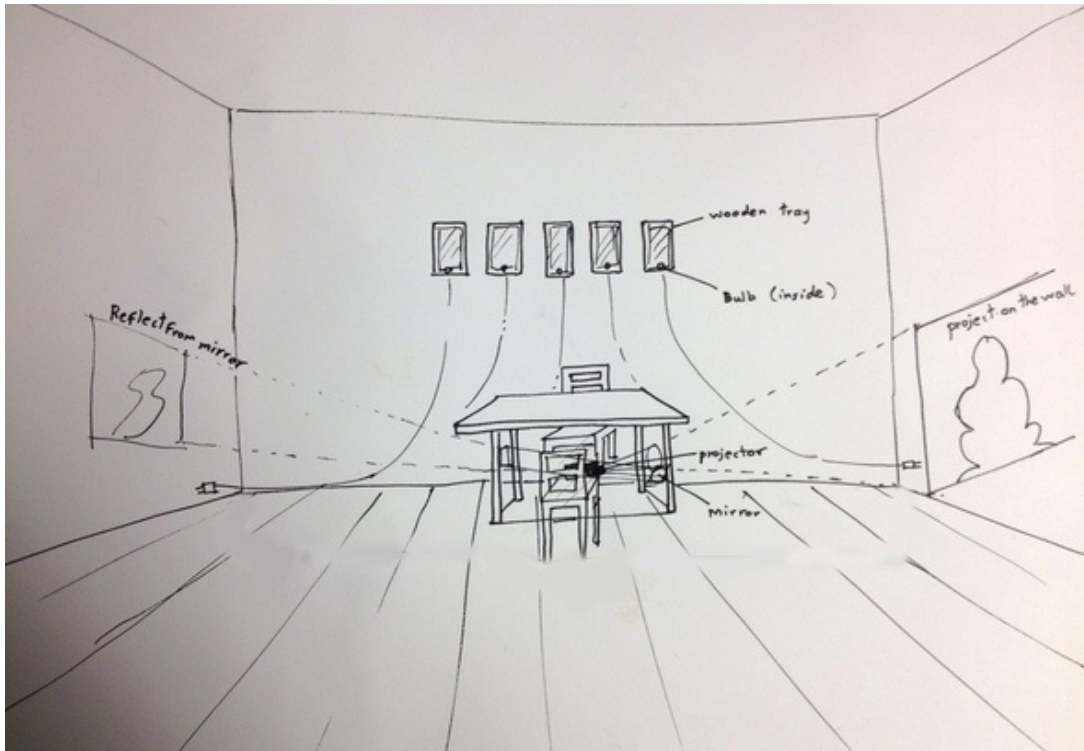

OPENING RECEPTION: THURSDAY, JUNE 5, 6–8PM

Exhibition dates: June 5- July 6, 2014

ROOSTER GALLERY

[190 ORCHARD STREET](#)

[LOWER EAST SIDE, NYC 10002](#)

MARIA LAET & AUNG MYAT HTAY: ENCOUNTERS is the 3rd edition of the JARO series of exhibitions developed each year by Residency Unlimited (RU) and [Rooster Gallery](#). Working across multiple mediums, both Laet and Htay are currently in residence at RU. Caroline Taylor brings them together to challenge the idea of an encounter, whether literally, emotionally or metaphorically. Inherent to their bodies of work is the concept of limits – both physical and mental – and the ability to see beyond what may at first appear common or mundane. The

artists, each coming from vastly different cultural backgrounds, create a common language through their practices - concepts penetrating well beyond the impermanent nature of physical objects and spaces utilized.

Brazilian artist [Maria Laet](#) creates a delicate yet profound language in her interventions. A series of actions in a surrounding space (either public or domestic) act as a conduit to a conceptual archive that informs her resulting works on paper and videos. Exploring physicality of materials such concrete, sand and milk, surface areas are stitched together in a poetic conversation between form and content. Presented are Laet's 2013 films *Leito (03)* and *Leito (04)*. By pouring and capturing milk flowing through cracks in concrete, subtle movements flatten into a formal, painterly gesture. In *Notes on the limit of the sea (2011)*, Laet stitches together the waterline of low tide of the sea – an action ultimately to be washed away. A new series of monoprints is also included in this exhibition in which the artist turned to the area in and around RU in Brooklyn. Frottages realized by the artist of cracks in the sidewalk and the interior of the RU floor space appear in ink on Japanese paper.

Based in Mandalay, Myanmar, [Aung Myat Htay](#) draws from his cultural background as reference in his works. Reconciling the traditional and contemporary, Htay juxtaposes cultural tradition and current political and social environments. Intrinsic to his work is translation of his Buddhist upbringing into his practice. For this exhibition, Htay produced a site-specific installation, *Dining Room Opera*, utilizing video and found objects. From underneath a table and chairs made of handmade paper, a video portraying traditional Burmese puppets is projected onto the nearby wall. Five light boxes covered in paper are installed on the wall opposite the table – the viewer looks inside to find images of the puppets once again. The table and chairs, left intentionally empty, give a feeling of coldness, or loneliness – while the puppets, with no puppet master or theater, are unable to perform. The new work focuses on the formation and evolution of culture and community within a population living under political or economic pressure. As relevant today, in a climate of mixed cultures, philosophies and theories, questions arise on the connections between humanity and art.

[More info here..](#)

---

## **RU Exhibition: Absence of Evil is the Evil of Absence**

**A site sensitive group show organized by RU resident artists  
Mikkel Carl and Pedro Wirz.**



*Pedro Wirz (work in progress)*

Wednesday June 11, 2014

6:00-8:00pm Free and open to the public

Upon appointment Thursday June 12, 2014

10:00am-6pm

Residency Unlimited

[360 Court Street #4 \(big green doors\)](#)

[Brooklyn, NY 11231](#)

Mikkel Carl and Pedro Wirz have selected specific works from a number of NY-based artists to deal with the rather peculiar space of the old church in Carroll St. housing Residency Unlimited. Work by Mikkel Carl, Liz Craft, Maja Cule, Olivia Erlanger, Lucas Knipscher, Sam Lipp, Carlos Reyes, Jessie Stead, Justin Swinburne, Andrew Norman Wilson, Pedro Wirz will be featured.

Within the framework of Mikkel Carl's and Pedro Wirz' residencies, this exhibition is made possible with the support of the Danish Arts Council and the International Exchange and Studio Program Basel.



INTERNATIONALES AUSTAUSCH- UND ATELIERPROGRAMM REGION BASEL  
INTERNATIONAL EXCHANGE AND STUDIO PROGRAM BASEL



STATENS  
KUNSTRÅD  
DANISH ARTS COUNCIL

About the artists:

[Mikkel Carl](#)

[Pedro Wirz](#)



---

## RU EXHIBITION: A public walk by Anna Smolak



*Katarzyna Krakowiak, SPECULATIONS, 5. ArtBoom Festival, Kraków; fot. Michał Ramus, courtesy The Krakow Festival Office.*

Monday June 23 2014

4-6pm – Free and open to the public

Residency Unlimited

[360 Court Street #4 \(big green doors\)](#)

[Brooklyn, NY 11231](#)

Join us for this public walk that reflects upon RU's singular architecture and the imaginary images it produces. This project is driven by narratives of artistic interventions between the curator [Anna Smolak](#) in dialogue with RU artists. Both the format of the artists-curator collaboration as well as the experience of the architecture and space will be discussed through the lens of Smolak's current investigations on issues of institutional critique. Select examples of works reflecting the curator's interests and background will be provided as an introduction to the walk.

Anna Smolak is a curator, editor and artistic producer based in Krakow, Poland. Between 2004-2012 she worked at Bunkier Sztuki Contemporary art Gallery in Krakow. She is currently collaborating as adjunct curator and program developer with BWA Sokół in Nowy Sącz. Her interest is based in contemporary institutional

critique and examining alternative modes of collaboration and organization. In her projects she has investigated the notion of margin, periphery and exclusion. In the recent years she analyzed the development of the art scene in the Eastern Partnership countries, focusing primarily on Georgia and Armenia.

Anna Smolak's curatorial residency is supported by the Adam Mickiewicz Institute, Warsaw, Poland



---

## RU TALK: 'Inside Out', Cadu speaks with Regine Basha



*Project Seasons 2012/2013. Credit: Caroline Bittencourt*

Tuesday June 24, 2014

6:30-8pm – Free and open to the public

Residency Unlimited

[360 Court Street #4 \(big green doors\)](#)

[Brooklyn, NY 11231](#)

[Eduardo Costa, or 'Cadu'](#) , a Brazilian artist now in residence at RU will have a conversation with independent curator [Regine Basha](#) regarding his work of the past ten years.

Though Cadu's work has manifested in various forms and formats, including large-scale sculptural installation, endurance drawing, abstract painting, musical performance, sound, and site-related public interventions, the approach is mostly driven by an intense curiosity of the unknown and investigations into systems of control, chance and chaos. With a natural propensity for engineering and scientific inquiry, Cadu's propositions are either crafted into an elaborate mechanical machines or presented as simply made objects or drawings - each provoking the parameters of sensorial experience which become at once humorous and ponderous. He has made drawing machines to track the trajectory of wind, a sensory-motor device to draw wall diagrams a-la-Sol Lewitt whenever a visitor enters the space, and diagrammatic drawings formed out of his electric bill illustrating variable usage over a month. A reoccurring motif lately has been the music box producing compositions from the random winning numbers of Brazilian lottery tickets.

Notions of conscious presence vs anonymity also continually alternate throughout Cadu's practice.

Between 2012 and 2013 Cadu spent 12 months living in isolation in a cabin he built into the forest canopy outside of Rio de Janeiro. There he produced drawings, sculpture and a journal of writing which acted as a guiding principle for much of the works to follow. At the other end of this spectrum is a seven-year long collaborative noise band 'Cavalo Project' which Cadu had brought together with artists as part of an open-ended, anti-individuation process that pushed the limits of collective practice.

Brazilian modernist traditions stemming from Lygia Clark or Helio Oiticica inhabit the work though Cadu also has affinities with artists such as Chris Burden, Fischil & Weiss or Roman Signer on various levels. With Regine Basha he will show work, discuss his time in isolation, share stories and facts about favorite early machines, and talk about his anticipated new exploration into the Atacama desert in Chile.

More info [about Cadu](#) & [Regine Basha](#).

We are grateful to the PIPA PRIZE for supporting Cadu's residency at RU.



---

## RU Talk: Screening Special Features



Thursday June 26, 2014

7:30pm - 9pm – Free and open to the public

Residency Unlimited

[360 Court Street #4 \(big green doors\)](#)

[Brooklyn, NY 11231](#)

Special Features 2014 is a film production program designed to support the creation of short films and videos by New York City based artists. Selected artists [Eunjung Hwang](#), [Angeline Gragasin](#), [James N. Kienitz Wilkins](#), and [Summer McCorkle](#), used or were inspired by the RU space to produce new works

“Special Features” refers to the additional material featured on DVD film releases. This reflects RU’s tailored residency approach to the creative process and is akin to the role of film production whereby filmmakers spend a large portion of time



and energy in the planning of their projects. The commonalities that can be found in both a customized RU residency and film-making highlight the making of process. This program brings the results of this process to the fore-front.

This program is supported by public funds from the New York City Department of Cultural Affairs in partnership with the City Council and the New York State Council on the Arts with the support of Governor Andrew Cuomo and the New York State Legislature.

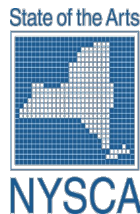

## OTHER NEWS

### Rodrigo Braga nominated for 2015 SAM Art Projects



Rodrigo Braga was recently nominated recipient of the prestigious [2015 SAM Art Projects](#) which includes a solo exhibition at the Palais de Tokyo in June 2015.

### Jakub Szczesny in MOMA collection

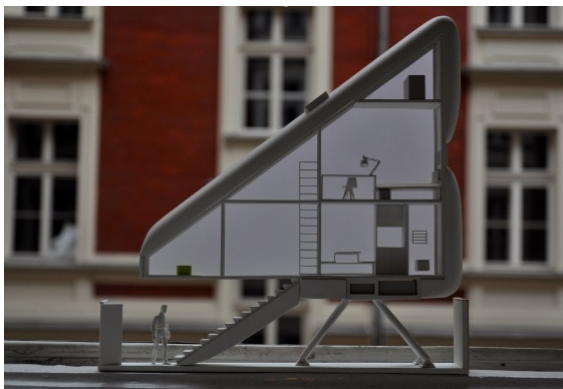

*Jakub Szczesny, Keret House*

Jakub Szczesny is entering the MOMA collection with a project that will be featured in the exhibition "[Conceptions of Space: Recent Acquisitions in Contemporary Architecture](#)" that opens on July 2.

### Maayan Sheleff curates The Infiltrators- ARtport Tel

## Aviv



If you happen to be in Tel Aviv in June, we invite you to visit Maayan Sheleff's exhibition "the Infiltrators" at [Artport Tel Aviv](http://artporttelaviv.org). Maayan will be a curator in residence at RU in the Fall 2014. "The Infiltrators" examines the local and global state of asylum seekers and refugees through works created with the

participation of communities of asylum seekers in Israel and elsewhere in the world.

### More info:

In Israel, the term "infiltrators" is used to describe the transgression of the country's political borders in order to commit a terrorist act. At the same time this term is commonly used to refer to Africans who have crossed the border into Israel. Alongside additional terms such as "refugees," "asylum seekers," and "immigrant workers," it plays an important role in the discussion of their status and future. In this context, the term "infiltrators" fixes the status of border crossers as that of liminal subjects, who remain trapped between here and there, citizens of a no place.

<http://infiltrators.artportlv.org>

## Lancheonete Question of the month #4: On Straddling



In last month's blog on straddling, I offered to share our idea on how a lunch counter, artist residency and related programming can reimagine the urban policy process in the Center of São Paulo ... and in the blog on status quo I

describe the project's value system. While I assert this humbly and with full knowledge of the evolution of policy thinking in the Western academy, the prospect of a process that can accommodate multiple story lines is one of the compelling reasons for making a project in Brazil.

[Read the full article here](#)

---

[About](#) / [Residencies](#) / [Activities](#) / [Dialogues](#) /  
[Opportunities](#)

[Contact Us](#) / [Support RU](#)

---



© 2009 - 2014 Residency Unlimited | 360 Court Street unit #4, Brooklyn NY 11231

[Web Version](#)

[Forward](#)

[Unsubscribe](#)

Powered by [Mad Mimi](#)®